

# ST100141MTL INCLUSIVE THERMOSTATIC SHOWER SET WITH G&G BAR (B)

# Metlex

PROFESSIONAL BATHROOM AND  
WASHROOM ACCESSORIES



**Finish:** Chrome plated.

### Features

- Assistive showering set with thermostatic mixer.
- Twin-stop safety device, comfort at 38°C with maximum hot temperature of 46°C.
- Safecool technology - Cold water insulates the mixer body making it cool to the touch.
- Five function handset with rub clean nozzles and an optional 'eco' feature.
- Integrated Grab 'n' Grip riser rail to stop wet hands from slipping.
- Simple lever operated controls and easy-press button operated slider.
- 2000mm hose with 11mm bore allows showering whilst in a seated position.
- Suitable for users upto 100kg (tested to 150kg).
- Simple fast fix 15mm inlet connections.

### Performance Standards

- BS EN 1111 Sanitary tapware - Thermostatic mixing valves (PN 10) - General technical specification.
- BS EN 12182 - Suitable For Users Up To 100kg When Fitted To A Solid Wall. Tested To 150kg.
- 3 Year Manufacturing Guarantee on Shower Kit.
- 5 Year Manufacturing Guarantee on Mixer Valve.
- Meets performance requirements for Service condition 3.

### Frequently Used Applications

Commercial washrooms, hotels, domestic & care homes.

### Care and Maintenance

Clean surfaces with a damp cloth and wipe dry using a soft cloth. Do not use chemical or abrasive cleaners as these may damage the surface finish.

## Specification

<b>Materials</b>	<b>ABS, Brass, Zinc, Thermoplastic Rubber, Grade 201 &amp; 304 Stainless Steel</b>
<b>Connection Inlet Type</b>	<b>15mm Compression - 150mm Spacing</b>
<b>Connection Outlet Type</b>	<b>Single Outlet, G 1/2" BSP</b>
<b>Dual Control</b>	<b>Thermostatic Temperature Control, Quarter-Turn Flow Control</b>
<b>Minimum Dynamic Pressure (Bar)</b>	<b>0.1 Bar</b>
<b>Maximum Dynamic Pressure (Bar)</b>	<b>5 Bar</b>
<b>Maximum Static Pressure (Bar)</b>	<b>10 Bar</b>
<b>Maximum Pressure Differential (Hot or Cold)</b>	<b>5:1</b>
<b>Maximum Inlet Temperature (Hot)</b>	<b>65°C</b>
<b>Maximum Inlet Temperature (Cold)</b>	<b>5°C</b>
<b>Pre-set Comfort Safety Stop Temperature</b>	<b>38°C(±2°C)</b>
<b>Maximum Safe Hot Water Temp (With Temp Limiting Device Installed)</b>	<b>46°C(±2°C)</b>
<b>Inlet Filter Washers (Replaceable)</b>	<b>Yes</b>
<b>Inlet Check Valves/Non-Return Valves (Single Valve)</b>	<b>Yes</b>
<b>European Water Label</b>	<b>8.57 litres/min</b>

Printed material, designs and packaging are protected by copyright and design rights.

**ST100141MTL**  
**INCLUSIVE THERMOSTATIC**  
**SHOWER SET WITH G&G BAR (B)**

**Metlex**

PROFESSIONAL BATHROOM AND  
 WASHROOM ACCESSORIES

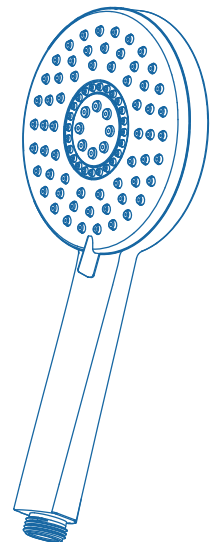
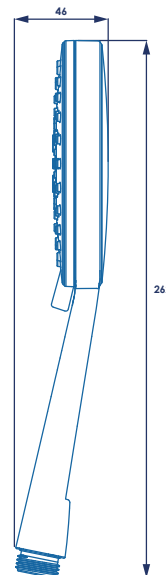
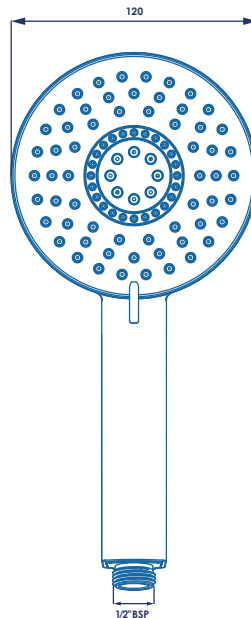
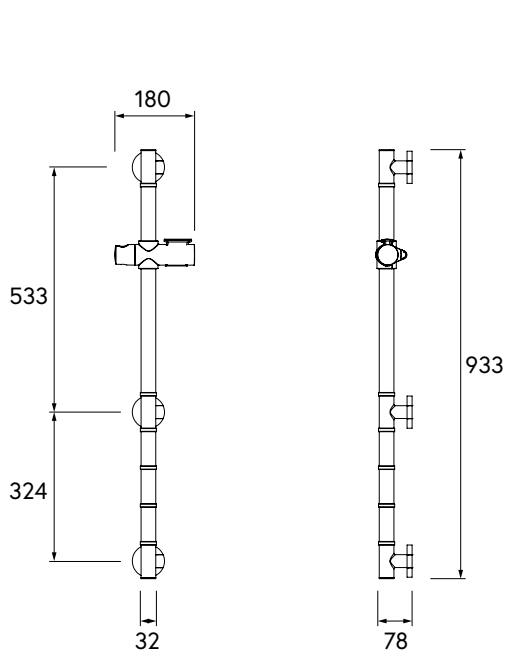
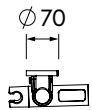
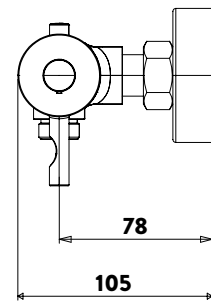
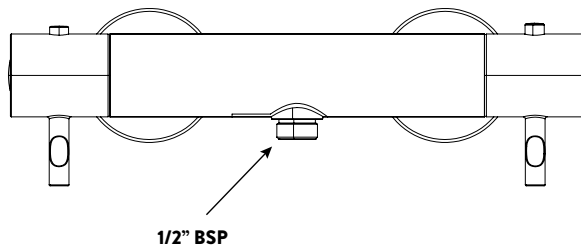
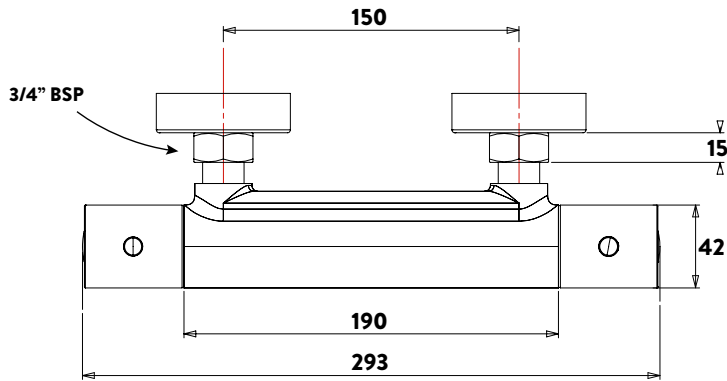

Printed material, designs and packaging are protected by copyright and design rights.